

## Testing Results for Lead in Drinking Water for Naval Air Station Oceana – SAC/Youth Center – Building 531

The Navy is committed to maintaining safe drinking water on its installations. City water supplied to the Navy and the Navy's water distribution system is regularly tested and in compliance with the Safe Drinking Water Act. Because lead exposure is a particular concern for children, and lead may be introduced to drinking water through the pipes, fittings, solder, and fixtures inside a building, the EPA recommends, but does not mandate, that we test the lead content of drinking water in priority areas such as youth centers (YC), child development centers (CDC), and child development group homes (CDGH).

Navy environmental personnel conducted lead testing at the NAS Oceana – YC – Building 531 in accordance with Navy and EPA guidelines. Samples from various locations in the YC were sent to a state-certified laboratory for analysis.

At the NAS Oceana – YC – Building 531, outlets used for drinking and cooking, as well as outlets used for hand washing were tested. All 19 of the outlets tested were within EPA's recommended lead level of 20 ppb. One part per billion is equal to one drop of water in an Olympic-size swimming pool.

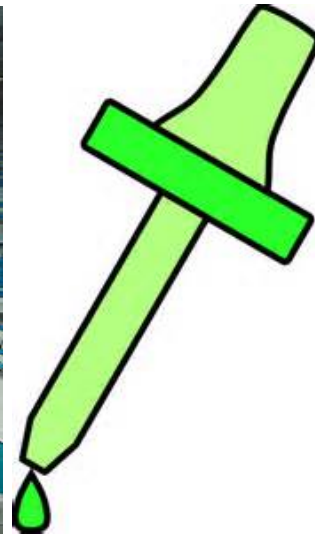

A copy of all test results is enclosed for your information. The test results are presented in two tables:

- Table 1 **Summary of Results** summarizes the data by category of use (e.g., drinking, cooking, washing).
- Table 2 **Summary Statistics** summarizes all the data.

**Table 1** provides a description of each sampling location using three columns; *Category*, *Outlet No.*, and *Outlet Description*. The *Category* column gives information about whether the outlet is used for drinking water (water fountain), cooking (food preparation), or washing (primarily hand-washing). The *Outlet No.* column is the number used to identify each outlet location and

corresponds to the outlet number on the floor plan. The *Outlet Description* column contains additional information to describe the outlet sampled under each category.

The next set of columns in **Table 1** provide *Initial Sampling Results*, and for those locations that exceeded the recommended level of 20 ppb, the *Re-sampling Results*.

EPA sampling protocol requires water to not be used for between 8 and 18 hours prior to first draw sampling. Therefore, the *Initial Sampling Results* include a sub-column for *First Draw* samples collected early in the morning before the YC opened and before any water was used. Additional sub-columns indicate whether *Retesting* is required and the *Date Secured* for fixtures greater than 20 ppb.

The *Re-sampling Results* columns are annotated N/A since all samples at the NAS Oceana – YC – Building 531 were within EPA recommended levels.

The *Corrective Actions* column describes actions that have been taken to remediate the source of lead. In the event that future fixtures or upstream piping is replaced, there are columns for *Post Remediation Sampling* data that will be documented to confirm that these corrective actions were successful in reducing lead below 20 ppb.

To learn more about lead in drinking water schools and day care centers visit this EPA website at: [http://water.epa.gov/drink/info/lead/schools\\_index.cfm](http://water.epa.gov/drink/info/lead/schools_index.cfm).

To learn more about your home's public water supplier, see their annual water quality report: Virginia Beach: <http://www.vbgov.com/government/departments/public-utilities/water-quality/Pages/default.aspx>

Navy Water Quality Reports:  
[http://www.cnic.navy.mil/regions/cnrma/om/environmental\\_support/water\\_quality\\_information.html](http://www.cnic.navy.mil/regions/cnrma/om/environmental_support/water_quality_information.html)

To answer any questions you may have on the sampling program contact the NAS Oceana Public Affairs Officer at 757-433-3155. If you have any health questions or concerns, we encourage you to call your health care provider or, if you are a TRICARE beneficiary, contact the Regional Nurse Advice Line (1-800-TRICARE, press option 1) or use the Regional Appointment Center at 1-866-645-4584 to schedule an appointment with your primary care provider.

Priority Areas Lead Testing and Corrective Actions (December 2014)  
NAS Oceana, SAC/Youth Center Building 531

Table 1. Summary of Results

SAMPLING LOCATION DESCRIPTION			INITIAL SAMPLING RESULTS		RE-SAMPLING RESULTS				CORRECTIVE ACTIONS	POST REMEDIATION SAMPLING RESULTS	
CATEGORY Water Intended For:	SAMPLE ID NO.	Outlet Description	First Draw (ppb)	Retest required?	Recommended Level = 20ppb					Description	Recommended Level = 20ppb
					Date Fixture Secured?	Water Fountain 15 min. Follow up Flush Sample - Collected day before First Draw Sampling (ppb)	First Draw (ppb)	Follow up Flush - Collected 30 seconds after First Draw Sampling (ppb)	First Draw (ppb)		Follow up Flush - Collected 30 seconds after First Draw Sampling (ppb)
SAMPLING DATE			11/25/2014								
RESULTS DATE			12/5/2014								
DRINKING	1	Hallway water fountain (cooler) A	non-detect	NO	N/A	N/A	N/A	N/A	N/A	N/A	N/A
DRINKING	2	Hallway water fountain (cooler) B	non-detect	NO	N/A	N/A	N/A	N/A	N/A	N/A	N/A
DRINKING	9	Kitchen water fountain (cooler)	non-detect	NO	N/A	N/A	N/A	N/A	N/A	N/A	N/A
DRINKING	11	Kitchen ice maker	non-detect	NO	N/A	N/A	N/A	N/A	N/A	N/A	N/A
DRINKING	15	Hallway water fountain (cooler) C	non-detect	NO	N/A	N/A	N/A	N/A	N/A	N/A	N/A
DRINKING	19	Locker Room water fountain (cooler)	non-detect	NO	N/A	N/A	N/A	N/A	N/A	N/A	N/A
COOKING	10	Kitchen sink for dishwashing, food prep	non-detect	NO	N/A	N/A	N/A	N/A	N/A	N/A	N/A
WASHING	3	Women's Visitor Restroom high hand washing faucet A	2	NO	N/A	N/A	N/A	N/A	N/A	N/A	N/A
WASHING	4	Women's Visitor Restroom high hand washing faucet B	1	NO	N/A	N/A	N/A	N/A	N/A	N/A	N/A
WASHING	5	Women's Visitor Restroom high hand washing faucet C	1	NO	N/A	N/A	N/A	N/A	N/A	N/A	N/A
WASHING	7	Men's Visitor Restroom high hand washing faucet A	1	NO	N/A	N/A	N/A	N/A	N/A	N/A	N/A
WASHING	8	Men's Visitor Restroom high hand washing faucet B	3	NO	N/A	N/A	N/A	N/A	N/A	N/A	N/A
WASHING	13	Girls' Restroom A high hand washing faucet A	non-detect	NO	N/A	N/A	N/A	N/A	N/A	N/A	N/A
WASHING	14	Girls' Restroom A high hand washing faucet B	non-detect	NO	N/A	N/A	N/A	N/A	N/A	N/A	N/A
WASHING	16	Boys' Restroom A high hand washing faucet	non-detect	NO	N/A	N/A	N/A	N/A	N/A	N/A	N/A
WASHING	17	Girls' Restroom B high hand washing faucet A	2	NO	N/A	N/A	N/A	N/A	N/A	N/A	N/A
WASHING	18	Girls' Restroom B high hand washing faucet B	2	NO	N/A	N/A	N/A	N/A	N/A	N/A	N/A
WASHING	21	Boys' Restroom B high hand washing faucet A	1	NO	N/A	N/A	N/A	N/A	N/A	N/A	N/A
WASHING	22	Boys' Restroom B high hand washing faucet B	non-detect	NO	N/A	N/A	N/A	N/A	N/A	N/A	N/A

Table 2. Summary Statistics

CATEGORY	INITIAL SAMPLING RESULTS		RE-SAMPLING RESULTS			POST REMEDIATION RESULTS
	First Draw	Water Fountain Follow up Flush Sample - Collected day before First Draw Sampling	Recommended Level = 20ppb		First Draw	
			First Draw (ppb)	Follow up Flush - Collected 30 seconds after First Draw Sampling		
Total Drinking	6	0	0	0	0	
Total Drinking > 20 ppb	0	0	0	0	0	
Total Cooking	1	0	0	0	0	
Total Cooking > 20 ppb	0	0	0	0	0	
Total Washing/Brushing	12	0	0	0	0	
Total Washing/Brushing > 20 ppb	0	0	0	0	0	
Total Samples	19	0	0	0	0	
Total Samples > 20 ppb	0	0	0	0	0	

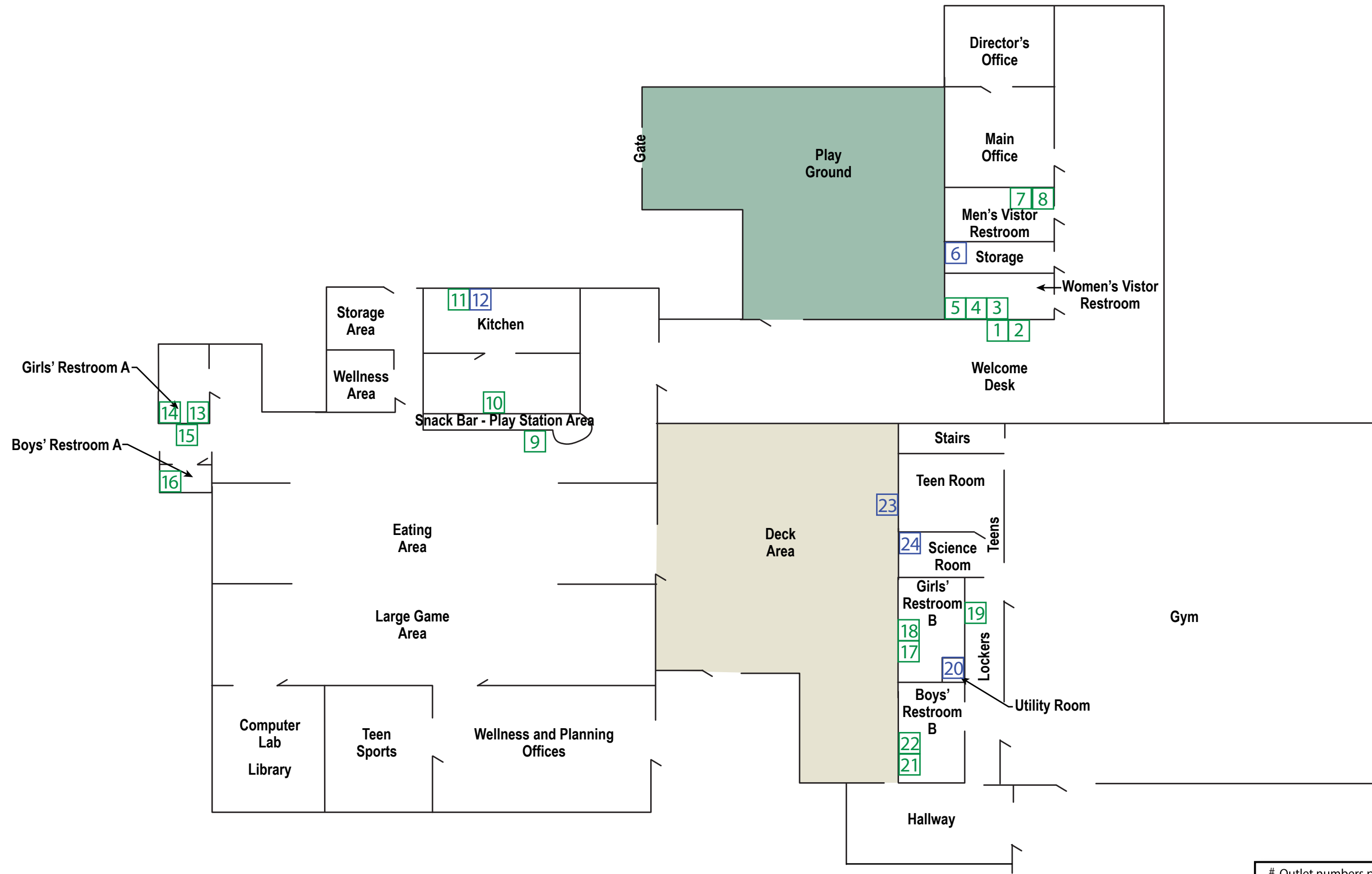

# Outlet numbers pertaining to the floor plan.  
 Red = Above 20 ppb  
 Green = Below 20 ppb  
 Blue = Not Sampled

### BUILDING 531 - FIRST FLOOR PLAN

•No outlets are located on the second floor so the second floor is not shown.

No.	Type of Fixture	Location Description	Sampled?	Exceeded?
1	Water fountain (cooler)	Hallway	Yes	No
2	Water fountain (cooler)	Hallway	Yes	No
3	High hand washing faucet A	Women's Visitor Restroom	Yes	No
4	High hand washing faucet B	Women's Visitor Restroom	Yes	No
5	High hand washing faucet C	Women's Visitor Restroom	Yes	No
6	Utility sink – not for drinking	Storage Room	No	N/A
7	High hand washing faucet A	Men's Visitor Restroom	Yes	No
8	High hand washing faucet B	Men's Visitor Restroom	Yes	No
9	Water fountain (cooler)	Kitchen	Yes	No
10	Kitchen sink for dishwashing, food preparation	Kitchen	Yes	No
11	Ice maker	Kitchen	Yes	No
12	Utility sink – not for drinking	Kitchen	No	N/A
13	High hand washing faucet A	Girls' Restroom A	Yes	No
14	High hand washing faucet B	Girls' Restroom A	Yes	No
15	Water fountain (cooler)	Hallway	Yes	No
16	High hand washing faucet	Boys' Restroom A	Yes	No
17	High hand washing faucet A	Girls' Restroom B	Yes	No
18	High hand washing faucet B	Girls' Restroom B	Yes	No
19	Water fountain (cooler)	Locker Room	Yes	No
20	Utility sink – not for drinking	Utility Room	No	N/A
21	High hand washing faucet A	Boys' Restroom B	Yes	No
22	High hand washing faucet B	Boys' Restroom B	Yes	No
23	Hose outlet – not for drinking	Outside (deck area)	No	N/A
24	Portable sink – not for drinking	Science Room	No	N/A

# Outlet numbers pertaining to the floor plan.

Red = Above 20 ppb

Green = Below 20 ppb

Blue = Not Sampled